

POS.NO.	DESCRIPTION	SPARE PART NO.
1 DC*	Dust Controller.....	100 001DC
2	Grid lid (hinge 100 mm).....	100 002
3	Mixer drum, excl. mixer gate.....	100 003
3 R	Rubber strap for grid lid.....	100 003R
4	Frame, complete w/wheels.....	100 004
4 B	Bucket stand.....	100 004B
4 F	Frame, front — u-shape.....	100 004F
4 L	Frame, left side.....	100 004L
4 R	Frame, right side.....	100 004R
4 T	Frame, top/rear.....	100 004T
5	Loading wheel (1 pc.), 80 mm, excl. bolt.....	100 005
5 B	Bolt (1 pc.) for 80 mm loading wheel.....	100 005B
6	Wheel (1 pc.), 300 mm, excl. bolt.....	100 006
6 B	Bolt (1 pc.) for 300 mm wheel.....	100 006B
6 W	Washer (1 pc.) for 300 mm wheel.....	100 006W
7	Mixer gate incl. bolt.....	100 007
8	Switch 16 Amp. w/thermal circuit breaker.....	100 008-110V
8 E	Safety switch — by the grid lid.....	100 008E
8 K	Cassette for safety switch, complete.....	100 008K
8 K1	Piece for safety switch, bended metal part.....	100 008K1
8 K2	Piece for safety switch, twisted metal part.....	100 008K2
8 K3	Piece for safety switch, rubber part.....	100 008K3
8 K4	Piece for safety switch, sleigh.....	100 008K4
9	Mixer arm (1 pc.), Side.....	100 009
10	Mixer arm (1 pc.), Side-base.....	100 010
11	Mixer arm (1 pc.), Rake.....	100 011
12	Drive shaft.....	100 012
12 A	Spring pins, complete set of 4 pcs. incl. a jig.....	100 012A
13	Gear motor 1,1 kW, 30 RPM, 110V.....	100 013-110V
13 G	- Gear only.....	100 013G
13 M	- Motor only.....	100 013M-110V
14	Starting capacitor 600 µF.....	100 014-110V_600
15	Operating capacitor 100 µF.....	100 015-110V_100
16	Phase capacitor 80 µF.....	100 016-110V_80
17 B	Telescopic leg (1 pc.), rear.....	100 017B
17 L	Telescopic leg (1 pc.), front — left side.....	100 017L
17 R	Telescopic leg (1 pc.), front — right side.....	100 017R
17 SB	Bolt and nut (1 set) for telescopic leg (1 pc.).....	100 017SB
19	Safety grid — by the mixer gate.....	100 019
20 *	Mixer arms w/rubber, 3 pcs., complete set.....	100 020
20 A*	Mixer arms w/rubber, 3 pcs., wo/cross joint.....	100 020A
21 *	Rubber (replacement set, complete).....	100 021
21 A*	Rubber (replacement set, blades only).....	100 021A
21 B*	Rubber (replacement set, for cross joint only).....	100 021B
22	Mixer arms, 4 pcs., complete set.....	100 022
22 A	Mixer arms, 4 pcs., wo/cross joint.....	100 022A
30	Discharge chute (incl. nuts).....	100 030
44	Cross joint for mixer arms, steel.....	100 044
47 *	Cross joint for mixer arms, rubber.....	100 047
48 *	Mixer arm w/rubber, Rake.....	100 048
49 *	Mixer arm w/rubber, Side-base.....	100 049
50 *	Mixer arm w/rubber, Side.....	100 050
51 *	Bracket for mixer blade, rubber, Rake.....	100 051
52 *	Bracket for mixer blade, rubber, Side-base.....	100 052
53 *	Bracket for mixer blade, rubber, Side.....	100 053

# SPARE PART LIST - 100L, 110V

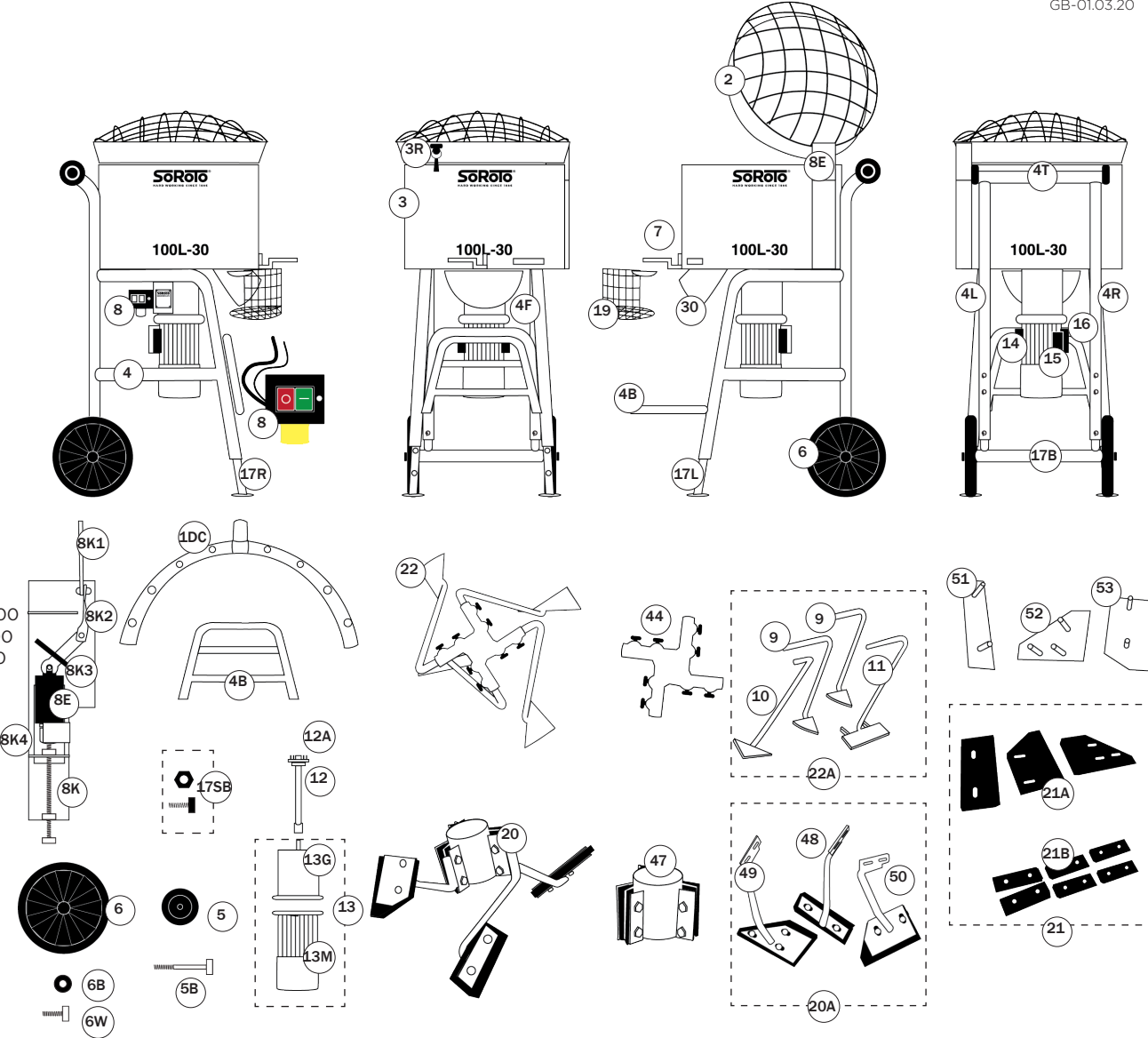

GB-01.03.20



\*OPTIONAL EXTRA